

ILLUMINATION PRESENTS
MINIONS



WAFFLE MAKER - INSTRUCTIONS FOR USE

Model: JD20336 | Product Ref 2066 | 220-240V, 50/60Hz, 650W

Thank you for purchasing this product. Please take time to read these instructions – they have been written to ensure you get the very best from your purchase.

PRODUCT SAFETY

When using electrical appliances, basic safety precautions should always be followed including:

1. Carefully read through this instruction manual and warning texts before using this appliance, save this instruction manual for future reference.
2. Always ensure the appliance is only used by a responsible adult.
3. Always use this appliance on a stable level surface.
4. Always ensure that hands are dry before handling the plug or switching on the appliance.
5. Never immerse the appliance cord or plug into water or any liquid. This is to protect against electric shock.
6. Always carry out regular checks on the appliance and power cord. In order to avoid hazard, should there be any sign of damage, do not attempt to use or repair. If the supply cord is damaged, it must be replaced by the manufacturer, its service agent or similarly qualified persons in order to avoid a hazard. This appliance has no user serviceable parts.
7. Always unplug this unit when not in use and before cleaning.
8. Always allow the appliance to fully cool down before cleaning or storing.
9. Never use this appliance for other than its intended use. The appliance is for household use only. Do not use outdoors.
10. Never let the power cord hang over the edge of the worktop, touch hot surfaces, become knotted, trapped or pinched.
11. Never place on or near a heat source.
12. Never leave this appliance unattended during use.
13. Never touch the exposed metal parts of the appliance during use as they will become very hot.
14. Never operate this appliance by means of an external timer or separate remote-control system.
15. This appliance can be used by children aged from 8 years and above and persons with reduced physical, sensory or mental capabilities or lack of experience and knowledge if they have been given supervision or instruction covering use of the appliance in a safe way and understand the hazards involved. Children shall not play with the appliance. Cleaning and user maintenance shall not be made by children unless they are older than 8 and supervised. Keep the appliance and its cord out of reach of children less than 8 years.
16. This appliance is intended to be used in the household and similar applications such as; farm houses; by clients in hotels, motels and other residential type environments; bed and breakfast type environments. It is not suitable for use in staff kitchen areas in shops, offices and other working environments.

ELECTRICAL SAFETY – WARNINGS!

Read these instructions thoroughly before using this appliance or connecting it to the mains supply.

A 13-amp BS1362 ASTA approved fuse must be fitted.

The appliance must be earthed.

There are no user serviceable parts inside this appliance.

In order to avoid hazard always refer servicing to qualified service personnel.

Do not allow this product to be exposed to water or moisture during use or storage.

Before switching on, make sure that the voltage of your electricity supply is the same as that indicated on the appliance's rating plate. Connecting it to any other power source may cause damage.

The mains lead of this product is not replaceable by the user. If the mains lead is damaged, the entire appliance should be replaced by a suitable qualified person in order to avoid hazard.

In order to avoid hazard, if the plug has to be changed because it is not suitable for your socket, or due to damage, it should be cut off and a replacement fitted by a qualified person. The old plug must be disposed of safely because inserting it into a 13-amp socket could cause an electrical hazard.

BEFORE FIRST USE

Remove any packaging material and any promotional labels. Before using your appliance for the first time, clean the baking plates with a damp cloth or sponge, do not allow water to run into the appliance. Slightly grease the baking plates with a little cooking oil. When your appliance is heated for the first time, it may emit a slight smoke or odour. This is normal with many heating appliances. This does not affect the safety of your appliance.

CARE AND CLEANING – WARNING!

- Always turn off the unit and allow to completely cool before cleaning.
 - Never immerse any part of your appliance, its cord or plug in water or any other liquid.
 - Before cleaning your appliance, unplug it from the mains supply and allow it to cool down completely. Clean the outer surface with a soft damp cloth.
 - The cooking plate is coated with a non-stick material. Therefore, little cleaning is required. Simply wipe the cooking plate over with a damp cloth.
 - Do not clean with metal scouring pads. Pieces can break off and touch electrical parts increasing the risk of electrical shock.
 - Do not use coarse or abrasive cleaners or steel wool to clean the appliance.
 - Never spray or apply cleaning products directly onto the appliance. Apply cleaner to a soft cloth instead.
 - Do not place this item in the dishwasher.
 - Before next use, lightly grease the cooking plate for easy removal of cooked waffles.
-

STORAGE

Unplug the appliance before storage. Ensure that the appliance has completely cooled down and is clean before storing away. Store your appliance in its packaging box in a clean dry place. Do not allow this product to be exposed to water or moisture during use or storage.

SERVICING

In order to avoid hazard if you drop or damage your appliance it should not be used until it has been examined by an authorised service centre or appliance technician. Always refer servicing to qualified service personnel.

THIS APPLIANCE IS FOR HOUSEHOLD USE ONLY.
WARNING: THIS APPLIANCE MUST BE EARTHED
PRODUCT SPEC: 220-240, 50/60Hz, 650W

DIAGRAM

Before using your appliance for the first time, you should become familiar with all of the parts. Read all the Instructions and Safeguards carefully.

1. Handle
2. Upper Housing
3. Ready Indicator Light (Red)
4. Bottom Non-stick Plate
5. Bottom Housing
6. Upper Non-stick Plate

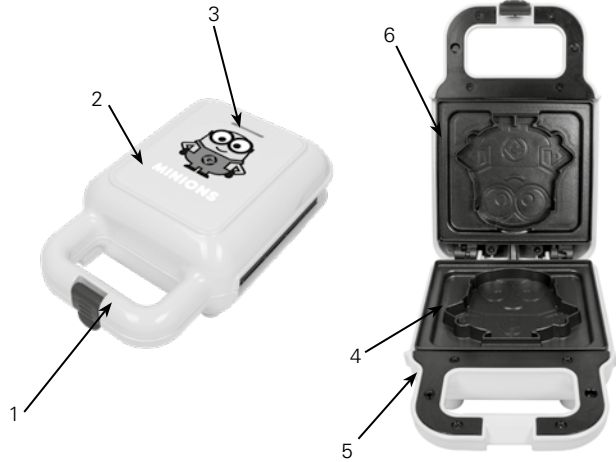

OPERATING INSTRUCTIONS

1. Place unit on a flat, dry, stable, protective and heat resistant surface. Make sure it is not in contact with a wall or curtains.



2. For best results, lightly spray the cooking plates with a cooking oil spray before using. This will assist in the removal of waffles after cooking.

3. Insert the pin plug into the power socket, you will notice that the red ready indicator light will come on, indicating that the Waffle Maker has begun preheating.

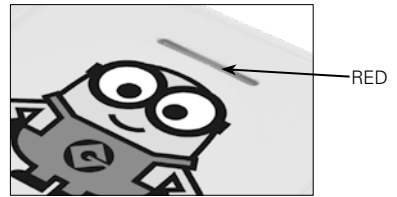

4. Allow your Waffle Maker to pre-heat until the ready indicator light goes out. This indicates that the cooking plates have reached the correct temperature for cooking.

5. Divide mixture evenly into the bottom waffle moulds as per recipes using a jug and spoon or fabric piping bag. Note: Do not use disposable plastic piping bags as these may melt if they come into contact with the hot plates.



6. Gently close the lid, ensuring the latch locks in place. Do not slam the lid down as it may cause the mixture to run off the cooking plates.



7. Be careful when closing the lid as the Waffle Maker may emit some steam.

8. Allow to cook for approximately 3-5 minutes or until golden.

9. To remove waffles, always use a plastic or wooden spatula. Never use a sharp object or metal, as this will damage the non-stick surface of cooking plates.



WAFFLE RECIPE INGREDIENTS (MAKES 8 - 10 WAFFLES)

- 200g plain flour
- 125g sugar
- 2 teaspoons baking powder
- A pinch of salt
- 125ml milk
- 50g melted butter
- Half teaspoon vanilla extract
- 1 egg

**PREPARE THE
WAFFLE MAKER WITH
NON-STICK SPRAY, AND
HEAT THE WAFFLE MAKER
ACCORDING TO
THE INSTRUCTIONS.**

METHOD

1. Mix the flour, salt, baking powder and sugar in a bowl and set aside.
2. In a separate bowl, beat the eggs. Stir in the milk, butter, and vanilla.
3. Pour the milk mixture in the flour mixture and beat until smooth.
4. Lightly coat the cooking plates with oil spray, then heat until the light turns off.
5. Pour your mix into each section, then gently close the lid.
6. After 3-5 minutes your waffles should be crisp and golden.
7. Place generous amounts of your favourite fruit and cream on top, then serve.

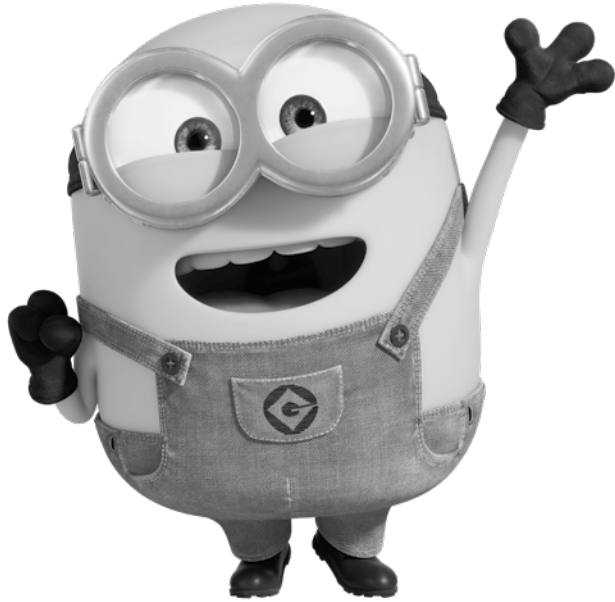

ILLUMINATION

© Universal City Studios LLC. All Rights Reserved.

WARNING! This item is not a toy. Keep out of reach of children. WEEE product should be disposed of by handing it over at a designated collection point. For more information about where you can drop off your waste product for recycling please contact your local authority. Made in China.

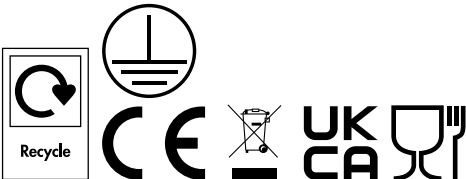

2066 0805 V3



6 Commerce Way, Lancing, BN15 8TA, UK
Distributed in the EU by Fizz Creations GMBH
Stadtweide 17, Emmerich, 46446, DE
www.fizzcreations.com

UK Ltd. & GMBH

© 2022 Fizz Creations Ltd. All rights reserved.