

# The Slush Bar



## Cocktail Slush Machine Instructions For Use

Model Number: BH9268 Product Ref: 2115 Voltage: 220-240V 50/60Hz Power: 25W V1



The  
Slush  
Bar



# CONTENTS



Safety Information ..... 1



Before You Begin ..... 2

- Identifying Parts
- What you will need
- Jug Measuring
- Making a Cocktail Slush
- Tips on using your Cocktail Slush Machine



Using the Machine ..... 3-4

- Making Cocktail Slush



Storage and Maintenance ..... 4

- Cleaning and Care
- Storage
- Servicing
- Technical Specification





# SAFETY INFORMATION

Please read these instructions carefully before assembling and using your Cocktail Slush Machine. We recommend you keep these instructions in a safe place for future reference.

- ✗ **NEVER** use any attachments or tools not included with the Cocktail Slush Machine. The use of these attachments may cause, fire, electric shock or injury.
- ✗ **NEVER** use the Cocktail Slush Machine for anything other than its intended use. The appliance is for household use only. This appliance is used indoors only. This appliance is intended to be used in household and similar applications: staff kitchen areas in shops, offices and other working environments; farm houses; by clients in hotels, motels and other residential type environments; bed and breakfast type environments.
- ✗ **NEVER** allow children to use the Cocktail Slush Machine, close supervision is necessary when this appliance is in use near children.
- ✗ **NEVER** let the power cord hang over the edge of the worktop, touch hot surfaces, become knotted, trapped or pinched.
- ✗ **NEVER** place on or near a heat source.
- ✗ **NEVER** leave the Cocktail Slush Machine unattended during use.
- ✗ **NEVER** touch the exposed metal parts of the appliance during use as they will become very hot.
- ✗ **NEVER** operate the Cocktail Slush Machine by means of an external timer or separate remote control system.
- ✗ **NEVER** immerse the power cord or plug into water or any other liquid. This is to protect against electric shock.
- ✓ **ALWAYS** ensure the Cocktail Slush Machine is only used by a responsible adult.
- ✓ **ALWAYS** use the Cocktail Slush Machine on a stable level surface.
- ✓ **ALWAYS** ensure that hands are dry before handling the plug or switching on the Cocktail Slush Machine.
- ✓ **ALWAYS** unplug this unit when not in use and before cleaning.
- ✓ **ALWAYS** allow the Cocktail Slush Machine to fully cool down before cleaning or storing.
- ✓ **ALWAYS** carry out regular checks on the Cocktail Slush Machine and power cord.

This appliance can be used by children aged from 8 years and above and persons with reduced physical, sensory, or mental capabilities. This machine can also be used by persons with lack of experience and knowledge if they have been given supervision or instruction concerning use of the appliance in a safe way and understand the hazards involved. Children shall not play with the appliance. Cleaning and user maintenance shall not be made by children without supervision.

## Electrical Safety

Please read these instructions thoroughly before using the Cocktail Slush Machine or connecting it to the mains electricity supply.

- A 3 amp BS1362 ASTA approved fuse must be fitted.
- There are no user serviceable parts inside the Cocktail Slush Machine. In order to avoid hazard always refer servicing to a qualified service personnel.
- Do not allow the Cocktail Slush Machine to be exposed to rain or moisture during use or storage.
- Before switching on, make sure that the voltage of your electricity supply is the same as that indicated on the Cocktail Slush Machine's rating plate. Connecting it to any other power source may cause damage.
- The supply cord cannot be replaced. If the cord is damaged, the appliance should be disposed of for recycling.



# BEFORE YOU BEGIN

## Identifying Parts:

1. Lid
2. Ice shaving chamber
3. Main body
4. Central Column
5. Selector dial
6. Mixing paddle
7. Jug



## What you will need...

We recommend that you use Cocktail Slush branded syrups. Carefully follow the instructions on the syrup bottle. To make 1 litre of Cocktail Slush, mix 835ml of

shaved ice to 165ml syrup. This is a guide. Should your mixture not produce the desired slush, you can add more ice or syrup as necessary.

### Ice Cubes

Make sure you have enough ice cubes on hand to fill the Ice Canister.

### Syrup

We recommend Cocktail Slush branded syrup. You can also use fruit juice!

## Jug Measuring

PLEASE NOTE: There are two measurements on the jug. Use Cocktail Slush measurements for Cocktail Slush syrups and use the embossed measurements for all other liquids.

## Making a Cocktail Slush

Using the Cocktail Slush measurements on the jug, pour the syrup into the jug to the required level. The rest of the jug will be filled with ice from the machine to create the perfect Cocktail Slush!

Measurements



## TIP: Using Your Cocktail Slush Machine

Your Slush Machine can make a maximum of 1 litre of Cocktail Slush mix in one go. DO NOT exceed the maximum capacity of 1 litre of liquid in the Cocktail Slush jug.



# USING THE MACHINE

## Making Cocktail Slush



1. Place the ice shaving chamber into the top of the main body. This may require some adjustment as this will only fit in if the position is correct.



2. Once firmly in place, lock the canister using the knob on top. This will click into place when fully locked.



3. Now place the mixing paddle into the jug as shown above.



4. Choose your desired liquid. This could be Cocktail Slush syrup, fizzy drinks or fresh juices. Using the clear markings, fill the jug to the desired amount. For Cocktail Slush syrups, use the printed markings. For other liquids, use the embossed markings.



5. Place the jug into the machine as shown in the image and rotate clockwise.



6. It is important the jug looks like the above image and is pushed as far clockwise as it will go.



7. Now add your ice to the canister. It is important you do not fill over the max fill line clearly shown on the canister.



8. Using the dial on the front, you can alter the settings depending on your requirements. Coarse will give you thicker chunks of ice and fine will give thin shavings to create a smooth slush.



9. Now place the lid on. There are two latches on the lid. The end with the On/Off markings should be facing towards the back of the machine. Now rotate the lid anti-clockwise and the machine will begin shaving your ice. To turn off the machine, rotate the lid clockwise.



10. You will notice that the ice will only fill the jug half full. Please refer back to Step 6 to fill a further half if required. If you require 500ml of slush, crush one round of ice. For 1 litre of slush, crush two rounds of ice.



11. Once mixed, turn the machine off by turning the lid clockwise. Remove the mixing jug by turning it anti-clockwise.

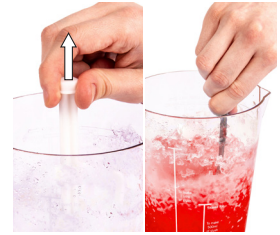

12. Once removed, remove the mixing paddle from the jug and hand stir the slush mixture with a spoon to ensure consistency. Simply serve your slush and enjoy!



## STORAGE & MAINTENANCE

### Cleaning and Care

To clean your Cocktail Slush Machine:

- 1 Unplug the Cocktail Slush Machine from the mains electricity supply and allow it to cool completely.
- 2 Remove all detachable parts.
- 3 Clean the detachable, non-electronic parts in lukewarm water with some washing-up liquid and rinse them under a tap.
- 4 Clean the outer surface of the Cocktail Slush Machine with a soft damp cloth.



#### IMPORTANT

Before cleaning your Cocktail Slush Machine, make sure the machine is turned off.



#### IMPORTANT

**DO NOT** immerse the Motor Unit in water or any other liquids.



#### IMPORTANT

**DO NOT** use coarse or abrasive cleaners or steel wool to clean the Cocktail Slush Machine.



#### IMPORTANT

**WARNING!** Contains functional sharp edges. Please take care when cleaning.



#### IMPORTANT

Never spray or apply cleaning products directly onto the Cocktail Slush Machine. If necessary, apply cleaner to a soft cloth instead.

#### IMPORTANT

**DO NOT** use a dishwasher to clean your Cocktail Slush Machine..

### Storage

To safely store your Cocktail Slush Machine:

- 1 Make sure the machine is turned off.
- 2 Unplug from the mains electricity supply.
- 3 Make sure the machine has completely cooled and is clean before storing.
- 4 Store the machine in its original packaging in a clean dry place. **DO NOT** allow the machine to be exposed to rain or moisture during use or storage.

### Servicing

If you drop or damage your Cocktail Slush Machine do not use it until it has been examined by an authorised service centre or appliance technician. Servicing must only be carried out by qualified service personnel. The Cocktail Slush Machine is for household use only.

### Technical Specification

Voltage: 220–240 V 50/60 Hz

Power: 25 Watts

Capacity: 1 litre



WARNING! This is not a toy. Wash before first use. Not suitable for dishwasher use. Remove all packaging before use. Unplug before cleaning. Do not immerse electrical parts in water or any other liquid. Keep out of the reach of children.

WEEE product should be disposed of by handing it over at a designated collection point. For more information about where you can drop off your waste product for recycling please contact your local authority. Suitable for indoor use only. Read instructions carefully before first use and retain this packaging for future reference.

Power Specification: 220-240V, 50/60Hz, 25W

FOR DOMESTIC USE ONLY.



6 Commerce Way, Lancing, BN15 8TA, UK  
Distributed in the EU by Fizz Creations GMBH  
Stadtweide 17, Emmerich, 46446, DE  
[www.fizzcreations.com](http://www.fizzcreations.com)

UK Ltd. & GMBH © 2022 Fizz Creations Ltd. All rights reserved.

0278  
2115